

REV.	REV. DATE	CHK. BY	CHK. DATE	ENG.	DESCRIPTION
18	03OCT05	WLL	22DEC05	DJB	UPDATED FURRING, SOURCE HOLDERS, WINDOW SIZE

**REVISIONS**

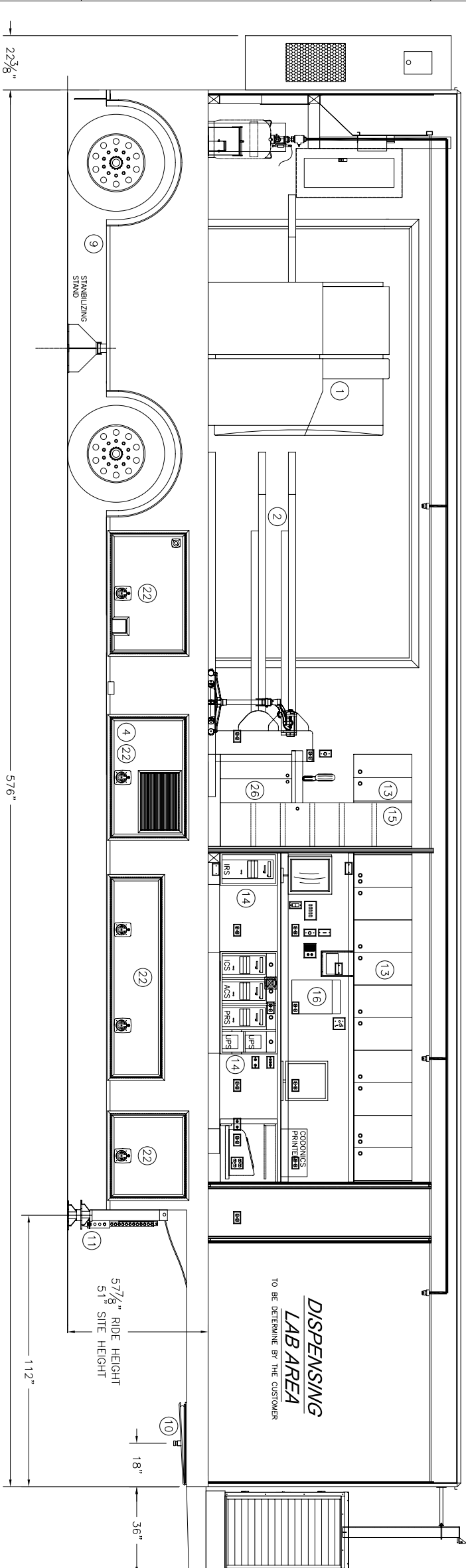
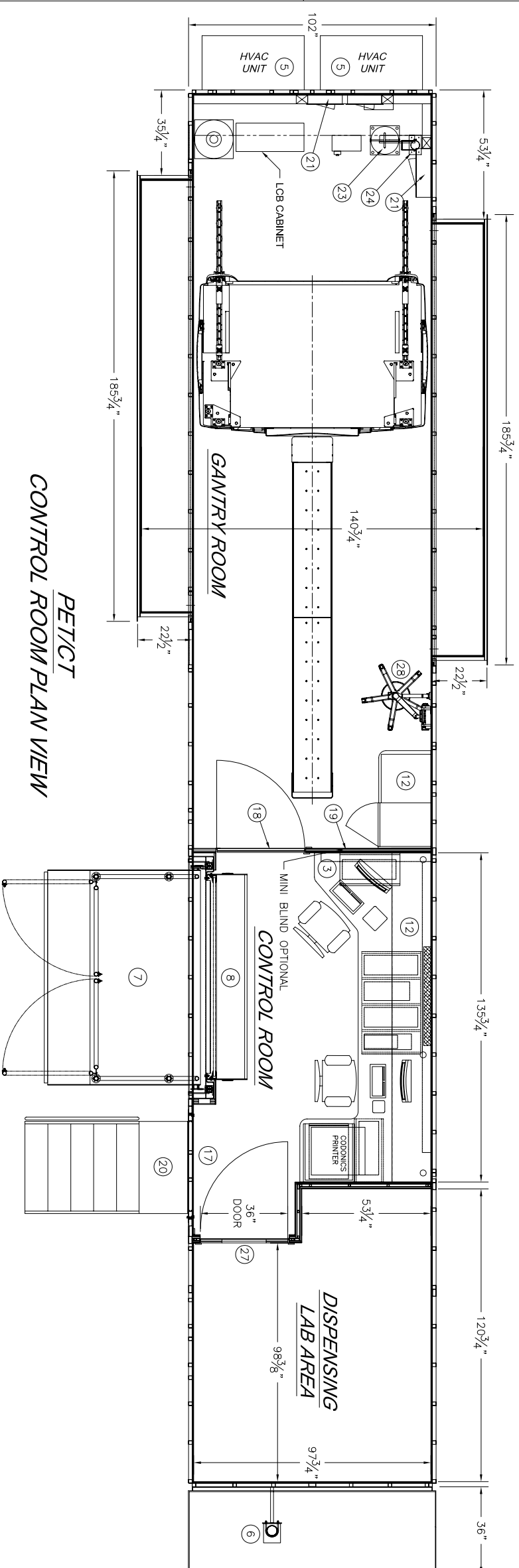

ITEM QTY	PART NUMBER	DESCRIPTION
28	1	MEDRAD INJECTOR - (CUSTOMER SUPPLIED OPTION)
27	1	36" x 94" LEADED DOOR w/ 18" x 36" LEADED WINDOW
26	1	UNDER COUNTER STORAGE CABINET
25	1	LINE CONTROL BOX (6-SLICE)
24	1	SMALL SOURCE
23	1	LARGE SOURCE HOLDERS
22	9	LOWER COMPARTMENT DOORS (4-PS / 5-DS)
21	2	ELECTRICAL SERVICE PANELS (1-480V / 1-208V)
20	1	ENTRY DOOR STAIRS & HANDRAIL
19	1	16" x 24" LEADED WINDOW
18	1	LEADED DOOR w/ 18" x 36" LEADED WINDOW
17	1	40" x 80" ENTRY DOOR
16	1	VIEWER
15	1	STORAGE CABINET
14	2	GPU CABINET
13	6	OVERHEAD STORAGE CABINET
12	3	WORK COUNTER
11	2	HYDRAULIC LEVELING LEGS, 31,000 LB. CAP
10	1	AIR RIDE UPPER COUPLER (KING PIN)
9	1	AIR RIDE SUSPENSION, 34,000 LB. CAP.
8	1	ROLL-UP DOOR, 7' x 6'-6"
7	1	PLATFORM LIFT - 89" WIDE ALUMINUM PLATFORM
6	1	100KW DIESEL GENERATOR
5	2	48,000 BTU AIR CONDITIONER
4	1	SYSTEM CHILLER
3	1	OPERATOR WORK STATION
2	1	PATIENT TABLE
1	1	PET/CT SCANNER

**BILL OF MATERIALS**

THIS DRAWING IS PROVIDED ON A CONFIDENTIAL BASIS SUBJECT TO RETURN ON DEMAND OF OSHKOSH SPECIALTY VEHICLES (OSHKOSH), WHICH RETAINS ALL RIGHTS ASSOCIATED WITH IT AND THE ARTICLE OR ARTICLES IT REPRESENTS. DISCLOSURE, REPRODUCTION OR ALTERATION OF ANY PART OF THIS DRAWING OR MANUFACTURE, USE OR SALE OF THE ARTICLE OR ARTICLES REPRESENTED IS PROHIBITED WITHOUT THE PRIOR WRITTEN AUTHORIZATION OF OSHKOSH. © OSHKOSH SPECIALTY VEHICLES (unpublished).

SHEET NUMBER: 1 OF 1  
 JOB#  
 GENERAL LAYOUT  
 SIEMENS MEDICAL MOBILE PET/CT  
 8'-0" X 13'-0" X 49'-0" TRAILER

DATE: 06AUG03  
 DRAWN BY: [Signature]  
 SCALE: 1/2"=1'-0"

CHECKED BY: [Signature]  
 DRAWING NUMBER: 100235-A01

OSHKOSH SPECIALTY VEHICLES  
 16745 S. LATHROP AVENUE  
 HARVEY, IL 60426  
 PHONE: (708) 596-5066  
 FAX: (708) 596-2480